

Figure 143. Transfer Case Mounting Hardware, Housing Flanges, and Speedometer Drive.

Current part is item (9,1,23,10) on diagram. Available at www.oshkoshequipment.com

(1)	(2)	(3)	(4)	(5)	(6)	(7)	(8)
ILLUS.							
(a)	(b)	SMR	NATIONAL	PART	DESCRIPTION	U/M	QTY
FIG.	ITEM	CODE	STOCK	NUMBER	FSCM		INC
NO.	NO.		NUMBER		USABLE ON CODE		IN
							UNIT
GROUP 0801 TRANSFER CASE ASSEMBLY							
FIG. 143 TRANSFER MOUNTING HARDWARE,							
HOUSING FLANGES, AND SPEEDMETER							
DRIVE							
143	1	PAFZZ	5305-00-071-2058	MS90728-92	96906	SCREW, CAP, HEXAGON	EA 2
143	2	PAFZZ	5310-01-133-3613	1229-E- 1513-C	78500	WASHER	EA 24
143	3	PAFFF	2520-01-146-3447	A3266-A-621	78500	COVER AND SEAL ASSEMBLY	EA 1
143	4	PAFZZ	3120-00-516-7516	1199-M-1105	78500	BEARING, SLEEVE	EA 1
143	5	PAFZZ	2520-01-127-2624	2297-S-3815	78500	SHAFT, SPEEDMETER GEAR	EA 1
143	6	PAFZZ	4730-00-202-9539	1199-N-1106	78500	REDUCER, TUBE	EA 1
143	7	PAFZZ	2520-01-137-4843	3264-W-101	78500	SHIELD AND DEFLECTOR	EA 1
143	8	PAFFF	2530-01-134-0900	A3268R- 1084	78500	SPIDER ASSEMBLY	EA 1
143	9	PAFZZ	5330-01-023-0269	A-1205- U-1737	78500	SEAL, PLAIN ENCASED	EA 1
143	10	PAFZZ	5305-01-135-3536	S-2914-C-1	70960	SCREW, CAP, HEXAGON	EA 7
143	11	PAFZZ	5310-00-725-1983	BACW10P53S	81205	WASHER, FLAT	EA 7
143	12	PAFZZ	5365-01-129-6590	1244-D-1590	78500	SPACER	EA 1
143	13	PAFZZ	5365-01-135-2829	2203-V-7848	78500	SHIM, .003	EA 1
143	13	PAFZZ	5365-01-135-2830	2203-W-7849	78500	SHIM, .005	EA 1
143	13	PAFZZ	5365-01-135-2831	2203-X-7850	78500	SHIM, .010	EA 1
143	14	PAFZZ	2520-01-139-4233	A-3289- G-189	78500	COVER, INSPECTION	EA 1
143	15	PAFZZ	5305-01-130-3267	S-265-1-C	78500	SCREW, CAP, HEXAGON	EA 8
143	16	PAFZZ	5340-01-089-2989	12256188	19207	BRACKET, MOUNTING	EA 1
143	17	PAFZZ	5310-00-241-6664	MS51943-44	96906	NUT, SELF-LOCKING	EA 7
143	18	PAFZZ	5307-01-121-9883	8331791-1	19207	STUD, PLAIN	EA 7
143	19	PAFZZ	5365-01-128-5061	2203-L-7786	78500	SHIM, .003	EA 1
143	19	PAFZZ	5365-01-133-3749	2203-M-7787	78500	SHIM, .005	EA 1
143	19	PAFZZ	5365-01-133-3750	2203-N-7788	78500	SHIM, .010	EA 1
143	20	PAFZZ	2520-01-139-3124	3266-F-864	78500	COVER, SHAFT	EA 1
143	21	PAFFF	2520-01-126-9364	A3266-A- 625	78500	COVER AND SEAL ASSEMBLY	EA 1
143	22	PAFZZ	5330-01-129-6589	A-1205-U- 1529	78500	SEAL, OIL	EA 1
143	23	PAFZZ	5365-01-180-2368	A-1250-X- 388	78500	PLUG, MACHINE THREAD	EA 1
143	24	PAFZZ	5305-00-338-5162	S-2710-1-C	78500	SCREW, SPECIAL	EA 22
143	25	PAFFF	2520-01-126-9363	A-3280-U- 7535	78500	FLANGE, DEFLECTOR	EA 1
143	26	PAFF	2520-00-255-5149	2297-C-627	97286	SLINGER	EA 1
143	27	PAFZZ	5310-01-129-4373	1229-T-1450	78500	WASHER, FLAT	EA 2
143	28	PAFZZ	5310-01-099-0397	1227-K-1051	14262	NUT	EA 2
143	29	PAFFF	2520-01-127-3595	A-3260-A-79	78500	YOKE AND DEFLECTOR	EA 1
143	30	PAFZZ	2520-00-255-5149	2297-C-627	97286	SLINGER	EA 1
143	31	PAFZZ	4730-01-068-0590	1850-Q-43C	78500	PLUG, PIPE	EA 1
143	32	PAFZZ	4730-00-595-4827	7521743	19207	PLUG, PIPE, MAGNETIC	EA 1

Current part is item (9,1,23,10) on diagram. Available at www.oshkoshequipment.com

Current part is item (9,1,23,10) on diagram. Available at www.oshkoshequipment.com

(1) ILLUS.	(2) (a) FIG. NO.	(3) (b) ITEM NO.	(4) SMR CODE	(5) NATIONAL STOCK NUMBER	(6) (4) PART NUMBER	(7) (5) FSCM	(8) (6) DESCRIPTION USABLE ON CODE	(9) (7) U/M	(10) (8) QTY INC IN UNIT
143	33	PAFFF	2520-01-134-3665	A-3266-Y-623	78500	COVER, TRANSFER CASE	EA	1	
143	34	PAFZZZ	5330-01-023-0269	A-1205-U-1737	78500	SEAL, PLAIN ENCASED	EA	1	
143	35	PAFZZ	5365-01-128-5062	2203-P-7790	78500	SHIM .003	EA	1	
143	35	PAFZZ	5365-01-128-5063	2203-Q-7791	78500	SHIM .005	EA	1	
143	35	PAFZZ	5365-01-128-5064	2203-R-7792	78500	SHIM .010	EA	1	
143	36	PAFZZ	5310-00-982-5009	MS51943-44	96906	NUT, SELF-LOCKING	EA	3	
143	37	PAFZZ	5340-00-741-1068	7411068	19207	MOUNT, RESILENT	EA	6	
143	38	PFFZZ	5340-01-089-2988	12256083	19207	BRACKET, MOUNTING	EA	1	
143	39	PAFZZ	5310-00-531-9120	7418962	19207	WASHER, FLAT	EA	3	
143	40	PAFZZ	5305-00-726-2556	MS90726-169	96906	SCREW, CAP, HEXAGON	EA	3	
143	41	PAFZZ	5315-00-010-6749	16-X-70	78500	KEY, WOODRUFF	EA	1	
143	42	PAFZZ	3020-01-126-8444	2297-T-3816	78500	GEAR, SPEED DRIVE	EA	1	
143	43	PAFZZ	5365-01-129-6849	1229-U-2829	78500	RING, RETAINING	EA	1	
143	44	PAFZZ	4730-01-132-6848	A-2206-D-56	78500	FITTING, FILTER	EA	1	

END OF FIGURE



Current part is item (9,1,23,10) on diagram. Available at www.oshkoshequipment.com

Section II.

TM 9-2320-272-34P-1

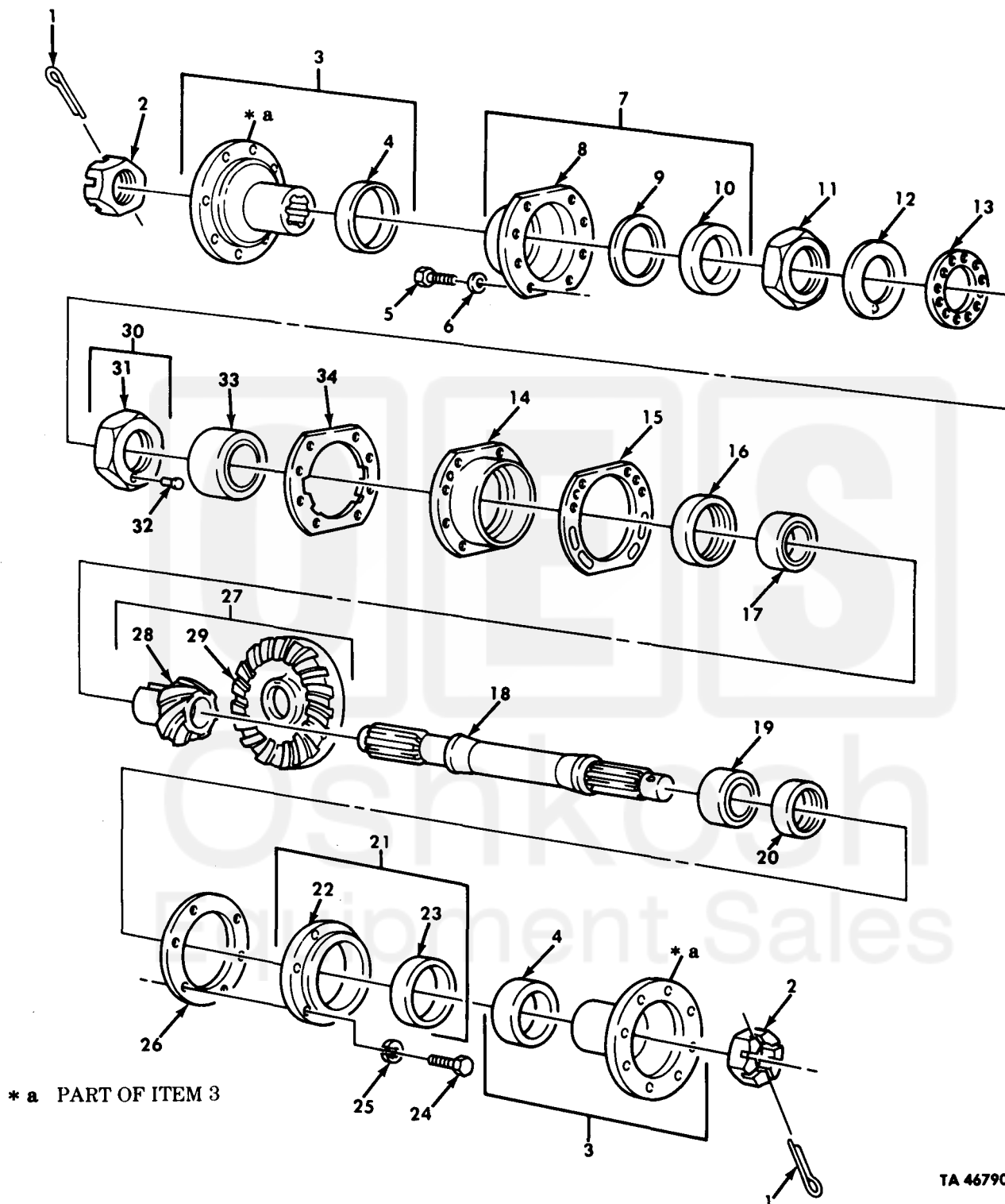

Figure 170. Front Axle Differential Through Shaft, Gears, and Flange Assemblies.

Current part is item (9,1,23,10) on diagram. Available at www.oshkoshequipment.com

(1)	(2)	(3)	(4)	(5)	(6)	(7)	(8)
ILLUS.							
(a)	(b)	SMR	NATIONAL	PART	DESCRIPTION	U/M	QTY
FIG.	ITEM	CODE	STOCK	NUMBER	FSCM		INC
NO.	NO.		NUMBER		USABLE ON CODE		IN
							UNIT
GROUP 1002 DIFFERENTIAL							
FIG.170 FRONT AXLE DIFFERENTIAL THROUGH							
SHAFT,GEARS AND FLANGE ASEMBLIES							
170	1	PAFZZ	5315-00-059-0184	MS24665-361	96906	PIN,COTTER	EA 2
170	2	PAFZZ3	5310-00-282-5661	7346893	19207	NUT,PLAIN,SLOTTED	EA 2
170	3	PAFFF	2520-00-734-6802	A3280G	78500	FLANGE,COMPANION	EA 2
				1957			
170	4	PAFZZ	2520-00-563-8309	7535048	19207	DEFLECTOR,DIRT	EA 1
170	5	PAFZZ	5305-00-018-0178	180178	24617	SCREW,CAP,HEXAGON	EA 8
170	6	PAFZZ	5310-00-249-6584	10947447	19207	WASHER,FLAT	EA 8
170	7	PAFFF	2520-00-734-6897	7346897	19207	COVER ASSEMBLY	EA 1
170	8	XAFZZ		8758251	19207	COVER,BEARING	EA 1
170	9	PAFZZ	5330-00-419-5872	10900396	19207	GASKET	EA 1
170	10	PAFZZ	5330-01-023-0269	A-1205-U-1737	78500	SEAL,PLAIN,ENCASED	EA 1
170	11	PAHZZ	5310-00-353-2427	7979263	19207	NUT,PLAIN	EA 1
170	12	PAHZZ	5310-00-147-3274	8758258	19207	WASHER,KEY	EA 1
170	13	PAHZZ	5310-00-700-7089	5139123	19207	WASHER,KEY	EA 1
170	14	PAHZZ	3110-00-419-9471	8758202	19207	PLATE,RETAINING	EA 1
170	15	KFHZZ		7346888	19207	SHIM .003,PART OF KIT P/N 7346807	EA 1
170	15	KFHZZ		7346889	19207	SHIM .005,PART OF KIT P/N 7340807	EA 1
170	15	KFHZZ		7346890	19207	SHIM .010,PART OF KIT P/N 7340807	EA 1
170	16	KFHZZ		8758209	19207	SPACER .367,PART OF KIT P/N 5704278	EA 1
170	16	KFHZZ		8758211	19207	SPACER .369,PART OF KIT P/N 5704278	EA 1
170	16	KFHZZ		8758213	19207	SPACER .371,PART OF KIT P/N 5704278	EA 1
170	16	KFHZZ		8758215	19207	SPACER .373,PART OF KIT P/N 5704278	EA 1
170	16	KFHZZ		8758217	19207	SPACER .375,PART OF KIT P/N 5704278	EA 1
170	16	KFHZZ		8758219	19207	SPACER .377,PART OF KIT P/N 5704278	EA 1
170	16	KFHZZ		8758221	19207	SPACER .379,PART OF KIT P/N 5704278	EA 1
170	16	KFHZZ		8758223	19207	SPACER .381,PART OF KIT P/N 5704278	EA 1
170	16	KFHZZ		8758225	19207	SPACER .383,PART OF KIT P/N 5704278	EA 1
170	16	KFHZZ		8758227	19207	SPACER .385,PART OF KIT P/N 5704278	EA 1
170	16	KFHZZ		8758229	19207	SPACER .387,PART OF KIT P/N 5704278	EA 1
170	16	KFHZZ		8758231	19207	SPACER .389,PART OF KIT P/N 5704278	EA 1
170	16	KFHZZ		8758233	19207	SPACER .391,PART OF KIT P/N 5704278	EA 1
170	16	KFHZZ		8758235	19207	SPACER .393,PART OF KIT P/N 5704278	EA 1
170	16	KFHZZ		8758237	19207	SPACER .395,PART OF KIT P/N 5704278	EA 1
170	16	KFHZZ		8758239	19207	SPACER .397,PART OF KIT P/N 5704278	EA 1
170	16	KFHZZ		8758241	19207	SPACER .399,PART OF KIT P/N 5704278	EA 1
170	16	KFHZZ		8758243	19207	SPACER .401,PART OF KIT P/N 5704278	EA 1
170	16	KFHZZ		8758245	19207	SPACER .403,PART OF KIT P/N 5704278	EA 1
170	17	PAHZZ	3110-00-100-5335	713536	21450	BEARING,ROLLER	EA 1
170	18	PAHZZ	3040-00-734-6892	7346892	19207	SHAFT,SHOULDERED	EA 1
170	19	PAHZZ	3110-00-195-0460	712148	78500	BEARING,ROLLER	EA 1
170	20	PAHZZ	3120-00-662-3370	7346894	19207	BEARING,WASHER	EA 1

Current part is item (9,1,23,10) on diagram. Available at www.oshkoshequipment.com

Current part is item (9,1,23,10) on diagram. Available at www.oshkoshequipment.com

(1) ILLUS.	(2) (a) FIG. NO.	(3) (b) ITEM NO.	(4) SMR CODE	(5) NATIONAL STOCK NUMBER	(6) PART NUMBER	(7) FSCM	(8) DESCRIPTION USABLE ON CODE	(9) U/M	(10) QTY INC IN UNIT
170	21	PAFFF		2520-00-734-6895	7346895	19207	CAP AND SEAL ASSEMBLY	EA	1
170	22	XAFZZ			8758207	19207	CAP	EA	1
170	23	PAFZZ		5330-01-023-0269	A-1205-U-1737	78500	SEAL,PLAIN ENCASED	EA	1
170	24	PAFZZ		5305-00-543-2419	MS90728-61	96906	SCREW,CAP,HEXAGON	EA	6
170	25	PAFZZ		5310-00-637-9541	MS35338-46	96906	WASHER,LOCK	EA	6
170	26	PAHZZ		5330-00-641-2466	7346896	19207	GASKET PART OF KIT P/N 7346807	EA	1
170	27	PAHZZ		3020-00-734-6881	7346881	19207	GEAR SET	EA	1
170	28	XAHZZ			8758204	19207	PINION,BEVEL	EA	1
170	29	XAHZZ			8758205	19207	GEAR,BEVEL	EA	1
170	30	PAHZZ		5310-00-374-0836	7979308	19207	NUT,PLAIN	EA	1
170	31	XAHZZ			7979309	19207	NUT,PLAIN	EA	1
170	32	XAHZZ			7979310	19207	PIN,ADJUSTMENT	EA	1
170	33	PAHZZ		3110-00-100-4177	703189	21450	BEARING,ROLLER	EA	1
170	34	PAHZZ		5330-00-734-6886	7346886	19207	GASKET	EA	1

END OF FIGURE



Current part is item (9,1,23,10) on diagram. Available at www.oshkoshequipment.com

Section II.

TM 9-2320-272-34P-1

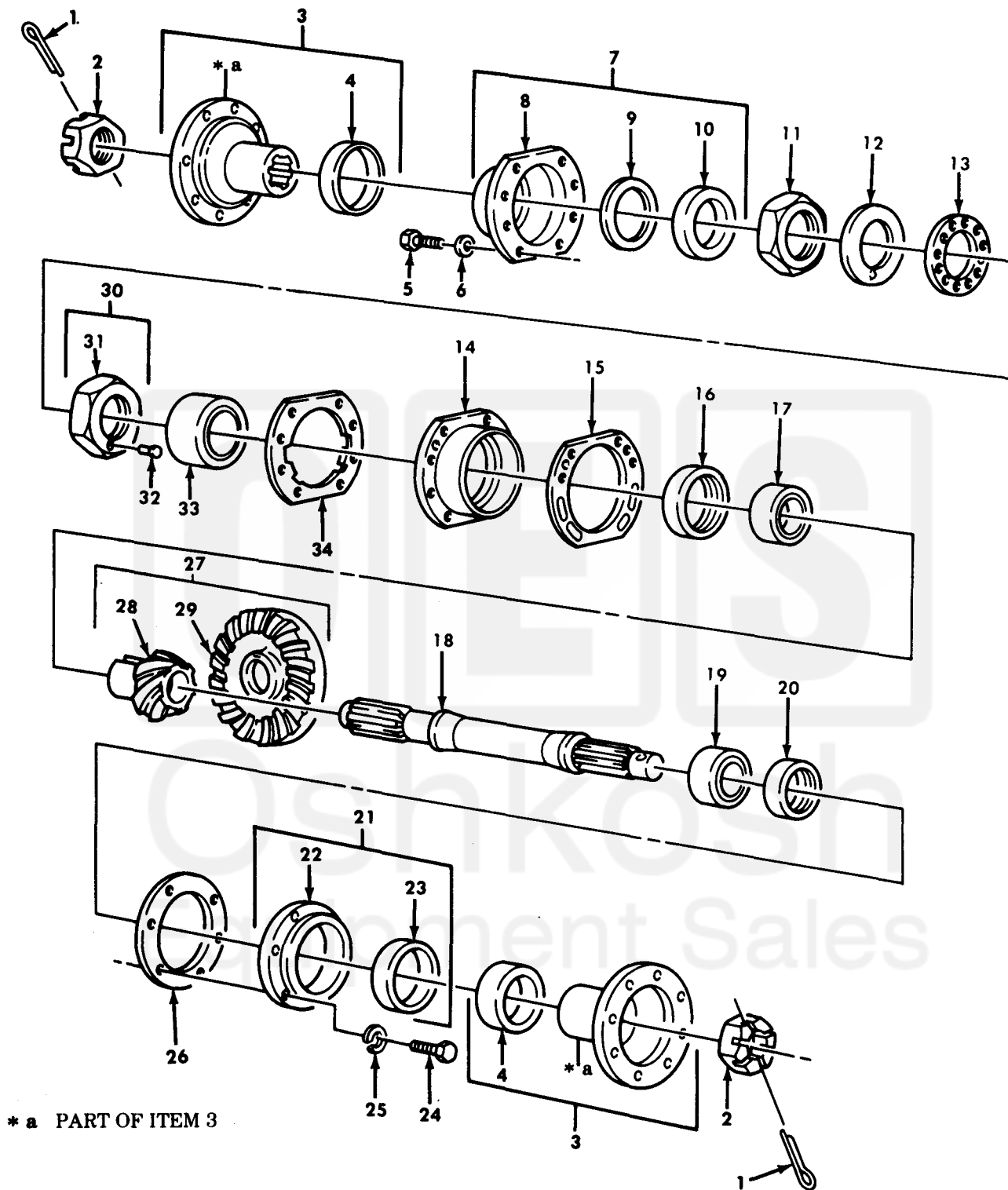

TA 467909

Figure 176. Rear Axle Differential Through Shaft, Gears, and Flange Assemblies.

Current part is item (9,1,23,10) on diagram. Available at www.oshkoshequipment.com

(1)	(2)	(3)	(4)	(5)	(6)	(7)	(8)
ILLUS.							
(a)	(b)	SMR	NATIONAL	PART	DESCRIPTION	U/M	QTY
FIG.	ITEM	CODE	STOCK	NUMBER	FSCM		INC
NO.	NO.		NUMBER		USABLE ON CODE		IN
							UNIT
GROUP 1102 DIFFERENTIAL							
FIG.176 REAR AXLE DIFFERENTIAL THROUGH							
SHAFT,GEARS,AND FLANGE ASSEMBLIES							
176	1	PAFZZ	5315-00-059-0184	MS24665-361	96906	PIN,COTTER	EA 2
176	2	PAFZZ	5310-00-282-5661	7346893	19207	NUT,PLAIN,SLOTTED	EA 2
176	3	PAFFF	2520-00-734-6802	A3280G	78500	FLANGE,TRANSFER	EA 2
				1957			
176	4	PAFZZ	2520-00-563-8309	7535048	19207	DEFLECTOR,DIRT	EA 1
176	5	PAFZZ	5305-00-018-0178	180178	24617	SCREW,CAP,HEXAGON	EA 8
176	6	PAFZZ	5310-00-249-6584	10947447	19207	WASHER,FLAT	EA 8
176	7	PAFFF	2520-00-734-6897	7346897	19207	COVER ASSEMBLY	EA 1
176	8	XAFZZ		8758251	19207	COVER	EA 1
176	9	PAFZZ	5330-00-419-5872	10900396	19207	GASKET	EA 1
176	10	PAFZZ	5330-01-023-0269	A-1205-U-	78500	SEAL,PLAIN ENCASED	EA 1
				1737			
176	11	PAHZZ	5310-00-353-2427	7979263	19207	NUT,PLAIN	EA 1
176	12	PAHZZ	5310-00-147-3274	8758258	19207	WASHER,KEY	EA 1
176	13	PAHZZ	5310-00-700-7089	5139123	19207	WASHER,KEY	EA 1
176	14	PAHZZ	3110-00-419-9471	8758202	19207	PLATE,RETAINING	EA 1
176	15	KFHZZ		7346888	19207	SHIM .003,PART OF KIT P/N 7346807	EA 1
176	15	KFHZZ		7346889	19207	SHIM .005,PART OF KIT P/N 7346807	EA 1
176	15	KFHZZ		7346890	19207	SHIM .010,PART OF KIT P/N 7346807	EA 1
176	16	KFHZZ		8758209	19207	SPACER .367,PART OF KIT P/N 5704278	EA 1
176	16	KFHZZ		8758211	19207	SPACER .369,PART OF KIT P/N 5604278	EA 1
176	16	KFHZZ		8758213	19207	SPACER .371,PART OF KIT P/N 5604278	EA 1
176	16	KFHZZ		8758215	19207	SPACER .373,PART OF KIT P/N 5604278	EA 1
176	16	KFHZZ		8758217	19207	SPACER .375,PART OF KIT P/N 5604278	EA 1
176	16	KFHZZ		8758219	19207	SPACER .377,PART OF KIT P/N 5604278	EA 1
176	16	KFHZZ		8758221	19207	SPACER .379,PART OF KIT P/N 5604278	EA 1
176	16	KFHZZ		8758223	19207	SPACER .381,PART OF KIT P/N5604278	EA 1
176	16	KFHZZ		8758225	19207	SPACER .383,PART OF KIT P/N5604278	EA 1
176	16	KFHZZ		8758227	19207	SPACER .385,PART OF KIT P/N 5604278	EA 1
176	16	KFHZZ		8758229	19207	SPACER .387,PART OF KIT P/N 5604278	EA 1
176	16	KFHZZ		8758231	19207	SPACER .389,PART OF KIT P/N 5604278	EA 1
176	16	KFHZZ		8758233	19207	SPACER .391,PART OF KIT P/N 5604278	EA 1
176	16	KFHZZ		8758235	19207	SPACER .393,PART OF KIT P/N 5604278	EA 1
176	16	KFHZZ		8758237	19207	SPACER .395,PART OF KIT P/N 5604278	EA 1
176	16	KFHZZ		8758239	19207	SPACER .397,PART OF KIT P/N 5604278	EA 1
176	16	KFHZZ		8758241	19207	SPACER .399,PART OF KIT P/N 5604278	EA 1
176	16	KFHZZ		8758243	19207	SPACER .401,PART OF KIT P/N 5604278	EA 1
176	16	KFHZZ		8758245	19207	SPACER .403,PART OF KIT P/N 5604278	EA 1
176	17	PAHZZ	3110-00-100-5355	713536	21450	BEARING,ROLLER	EA 1
176	18	PAHZZ	3040-00-734-6892	7346892	19207	SHAFT,SHOULDERED	EA 1
176	19	PAHZZ	3110-00-195-0460	712148	78500	BEARING ROLLER	EA 1
176	20	PAHZZ	3120-00-662-3370	7346894	19207	BEARING,WASHER	EA 1

Current part is item (9,1,23,10) on diagram. Available at www.oshkoshequipment.com

Current part is item (9,1,23,10) on diagram. Available at www.oshkoshequipment.com

(1) ILLUS.	(2) (a) FIG. NO.	(3) (b) ITEM NO.	(4) SMR CODE	(5) NATIONAL STOCK NUMBER	(6) PART NUMBER	(7) FSCM	(8) DESCRIPTION USABLE ON CODE	(9) U/M	(10) QTY INC IN UNIT
176	21	PAFFF		2520-00-734-6895	7346895	19207	CAP AND SEAL ASSEMBLY	EA	1
176	22	XAFZZ		8758207	8758207	19207	CAP	EA	1
176	23	PAFZZ		5330-01-023-0269	A-1205-U-1737	78500	SEAL,PLAIN,ENCASED	EA	1
176	24	PAFZZ		5305-00-543-2419	MS90728-61	96906	SCREW,CAP,HEXAGON	EA	6
176	25	PAFZZ		5310-00-637-9541	MS35338-46	96906	WASHER,LOCK	EA	6
176	26	KFHZZ		5330-00-641-2466	7346896	19207	GASKET PART OF KIT P/N 7346807	EA	1
176	27	PAHZZ		3020-00-734-6881	7346881	19207	GEAR SET	EA	1
176	28	XAHZZ		8758204	8758204	19207	PINION,BEVEL	EA	1
176	29	XAHZZ		8758205	8758205	19207	GEAR,BEVEL	EA	1
176	30	PAHZZ		5310-00-374-0836	7979308	19207	NUT,PLAIN	EA	1
176	31	XAHZZ		7979309	7979309	19207	NUT,PLAIN	EA	1
176	32	XAHZZ		7979310	7979310	19207	PIN,ADJUSTMENT	EA	1
176	33	PAHZZ		3110-00-100-4177	703189	21450	BEARING,ROLLER	EA	1
176	34	PAHZZ		5330-00-734-6886	7346886	19207	GASKET PART OF KIT P/N 7346807	EA	1

END OF FIGURE



Current part is item (9,1,23,10) on diagram. Available at www.oshkoshequipment.com